



HERDEN IMMOBILIEN®

— *Finest Properties* —



LONG TERM RENTAL LUXURY FLAT FOR RENT IN PRIME LOCATION OF PORTIXOL

3.100 €

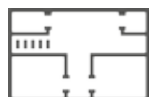

110 m²



3



3

Description

Luxury flat in prime location

Experience the epitome of luxury and comfort! This stunning luxury flat is situated in a prime location on the first sea line and offers direct access to the boulevard and the beach - the perfect place for your new home.

Highlights of the flat:

Spectacular royal sea views: Enjoy a 1A++ sea view that will take your breath away. Be mesmerised by the beauty of the Mediterranean while you relax in your spacious living room.

Dreamlike rooms:

The flat covers approximately 110 square metres and has 3 bedrooms and 3 luxurious bathrooms (including an ensuite), all with exquisite marble floors and baths.

Modern amenities:

The high-quality fitted kitchen is ideal for culinary creations, while the fitted wardrobes provide additional storage space. Enjoy the convenience of air conditioning and a lift for easy access to your floor.

Inviting living area:

The large, open-plan living area not only offers space to relax, but also spectacular views over the sea and the boulevard of Portixol. Here you can enjoy the sunset to the full.

Additional features:

Balcony:

Enjoy fresh air and first-class views from your own balcony.

Underground parking space:

An underground parking space is included in the rental price for your added convenience.

Unfurnished:

The flat is offered unfurnished, so you have the opportunity to bring in your personal style and taste.

Rental conditions:

The monthly rent is 3,100 euros, including utilities, plus electricity. A deposit of 3 months' rent is required.

Your property expert:

This exclusive offer is presented to you by Manfred Herden of Herden Immobilien Mallorca - a specialist and professional with over 33 years of experience in the field of high-quality property.

Do not hesitate! Arrange a viewing today and be inspired by this unique flat.

Your dream life by the sea is waiting for you!



More info

Utility surface 120 m²

1st Line sea

Lift

Heating

Balcony

Resilient door

Air condition

Outside



Energy rating



